



15 Abbotsford Road, Liverpool, Merseyside L23 6UX

£795 PCM

Berkeley Shaw Estate Agents are pleased to offer TO LET UNFURNISHED 1 Bedroom Ground Floor Apartment, The building has been subject to an exceptional conversion of this beautiful period building, set in the heart of Blundellsands, one of Liverpool's most affluent suburbs. Located close to local transport links.

The property comprises of Lounge, dining room, kitchen with appliances include fridge/freezer, electric oven, gas hob, dishwasher, washing machine, microwave. two bedrooms, bathroom and en-suite to master bedroom. The property benefits from double glazing, gas central heating, carpets, parking to front of property, communal gardens.

Property can be rented Furnished as seen in photos, this will be at an increased rental.

NO SMOKERS & NO PETS.

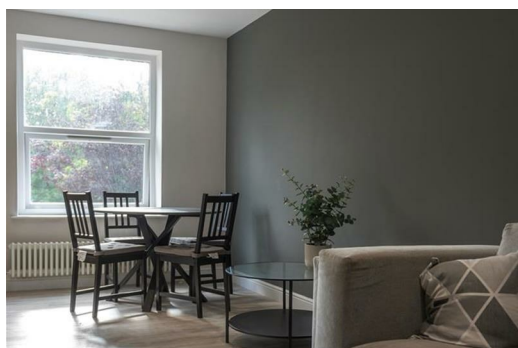

Energy Efficiency Rating		
	Current	Potential
Very energy efficient - lower running costs		
(92 plus) A		
(81-91) B		
(69-80) C		
(55-68) D		
(39-54) E		
(21-38) F		
(1-20) G		
Not energy efficient - higher running costs		
England & Wales EU Directive 2002/91/EC		

Environmental Impact (CO ₂) Rating		
	Current	Potential
Very environmentally friendly - lower CO ₂ emissions		
(92 plus) A		
(81-91) B		
(69-80) C		
(55-68) D		
(39-54) E		
(21-38) F		
(1-20) G		
Not environmentally friendly - higher CO ₂ emissions		
England & Wales EU Directive 2002/91/EC		

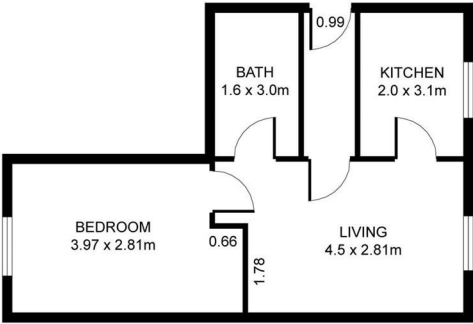

Berkeley Shaw Estate Agents Limited.
 Company No. 0784754

Berkeley Shaw Real Estate Limited.
 Company No. 05206927

