



## Portside House, 29 Duke Street, Liverpool, L1 5AQ

£795 PCM

Berkeley Shaw are pleased to offer to rent this FURNISHED One bedroom FURNISHED apartment in Portside House. located in the heart of Liverpool City Centre and just a two minute walk from the Liverpool One shopping complex. The accommodation briefly comprises; entrance hall, living/dining room fully fitted kitchen, two bedrooms and a main bathroom. No Parking with this apartment

Deposit: £795.00

Council Tax: Band B

Minimum Term: 12 months



## Hallway

Entrance door , wooden floor, storage cupboard

## Open Plan Lounge Kitchen

Double glazed widows, wooden floor in lounge area and tiled in kitchen area, kitchen comprises of a range of fitted base and wall units single drainer sink with mixer taps, electric oven an and Hob, extractor hood, freestanding washing machine and fridge freezer, 2 electric wall heaters furnishings include, table and chairs tv cabinet

## Bedroom`

Double glazed window, carpet, wall heater, furnishings include bed and bedside cabinets wardrobe and chest of drawers, electric wall heqater

## Bathroom

fully tiled walls and flooring, bath with fitted shower, sink and low leve w.c. ladder towel rail

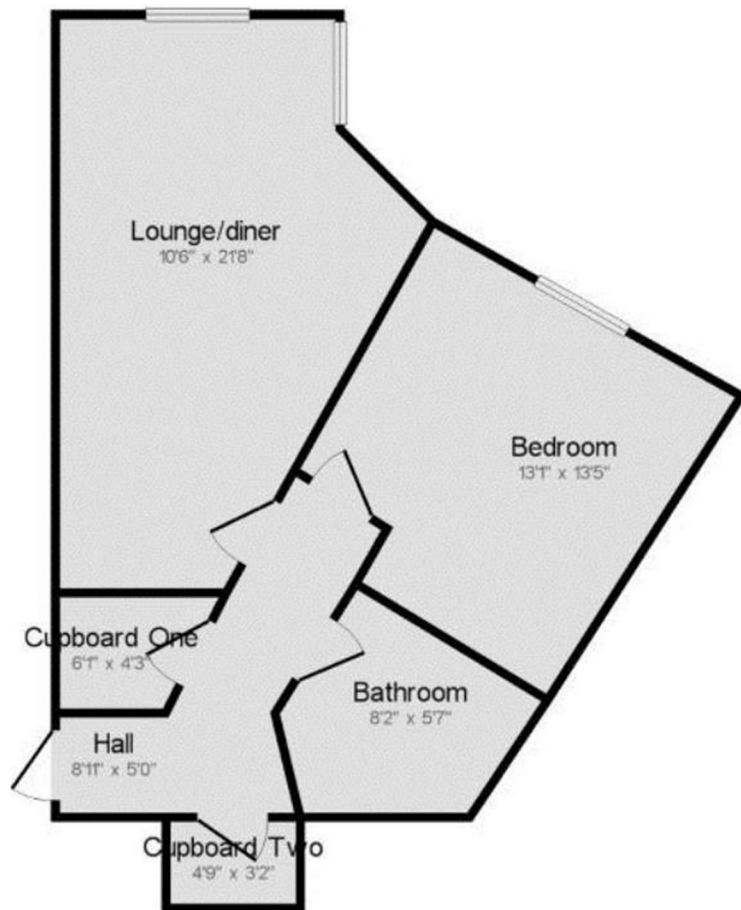

Ground Floor

Energy Efficiency Rating		
	Current	Potential
Very energy efficient - lower running costs		
(92 plus) A		86
(81-91) B		
(69-80) C	68	
(55-68) D		
(39-54) E		
(21-38) F		
(1-20) G		
Not energy efficient - higher running costs		
England & Wales	EU Directive 2002/91/EC	

Environmental Impact (CO <sub>2</sub> ) Rating		
	Current	Potential
Very environmentally friendly - lower CO <sub>2</sub> emissions		
(92 plus) A		77
(81-91) B		
(69-80) C	70	
(55-68) D		
(39-54) E		
(21-38) F		
(1-20) G		
Not environmentally friendly - higher CO <sub>2</sub> emissions		
England & Wales	EU Directive 2002/91/EC	



Berkeley Shaw Estate Agents Limited.  
Company No. 0784754

Berkeley Shaw Real Estate Limited.  
Company No. 05206927

